



**HYDROSTRESS
PARTS LIST**

**WSE1621
INVERTER**

MAY, 2024

Table of Contents

<u>Description</u>	<u>Page No.</u>
1. Exploded View	4-7
2. Parts Breakdown	8-10
3. Notes	12
4. Warranty.....	14

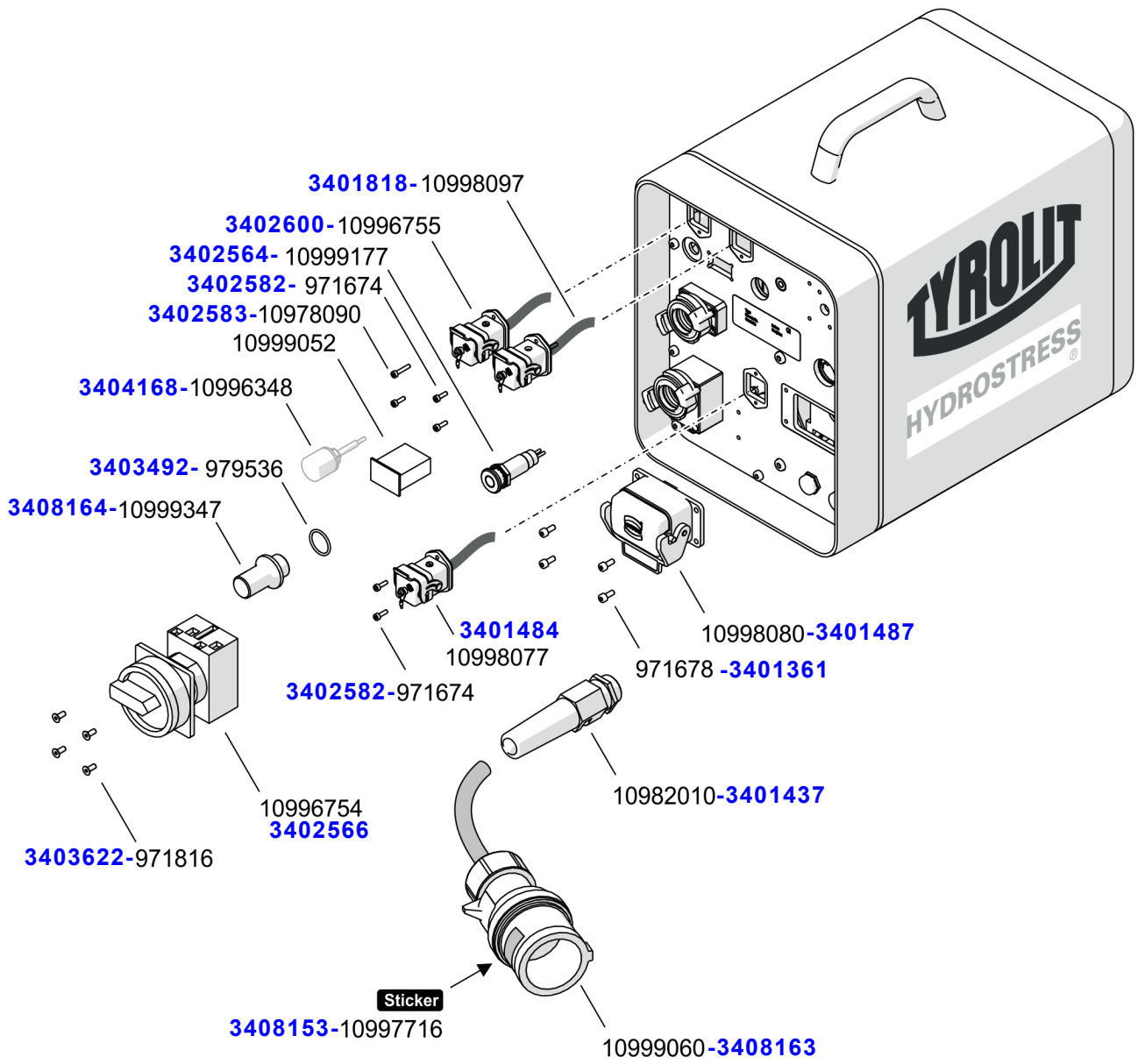

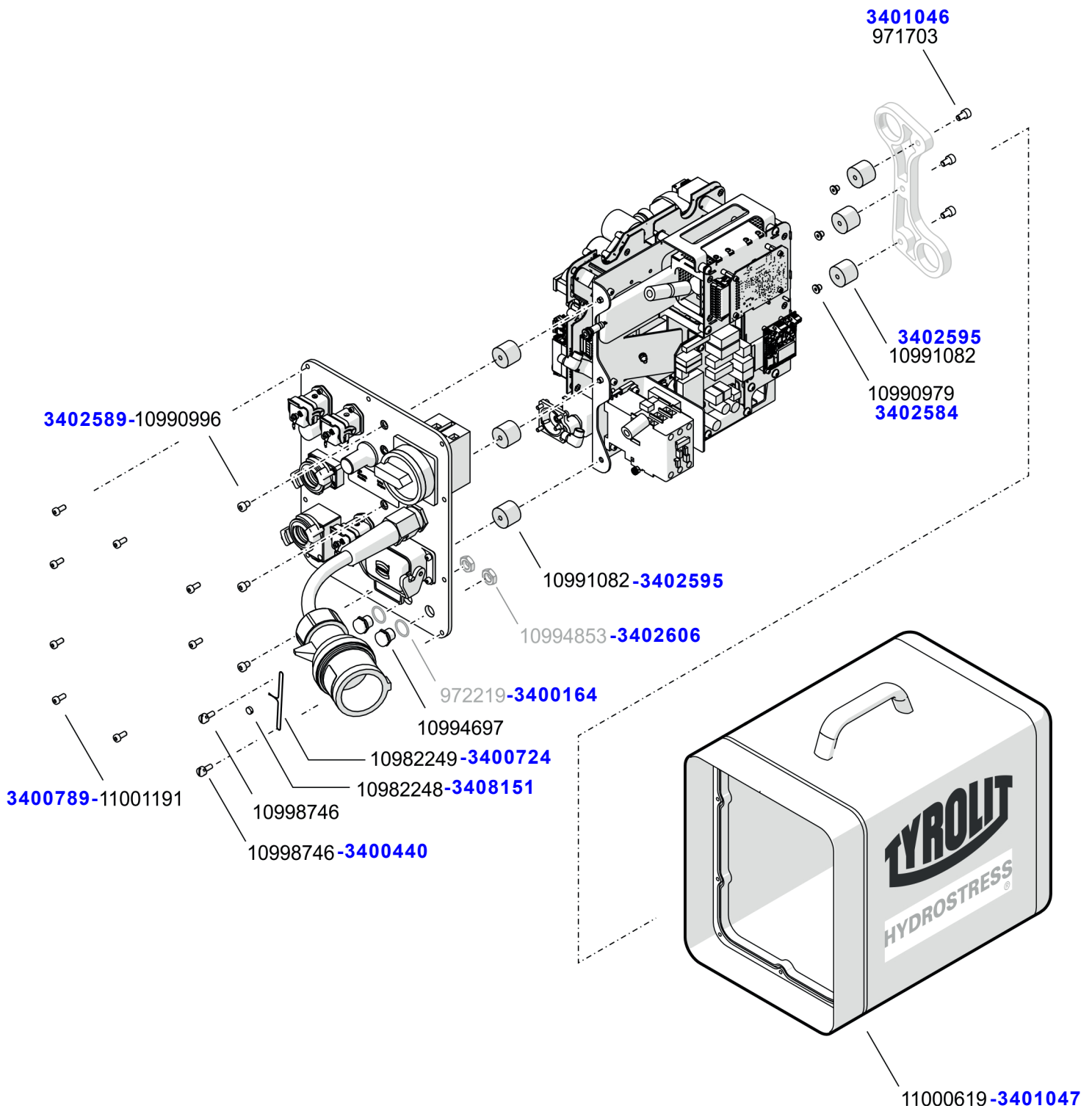

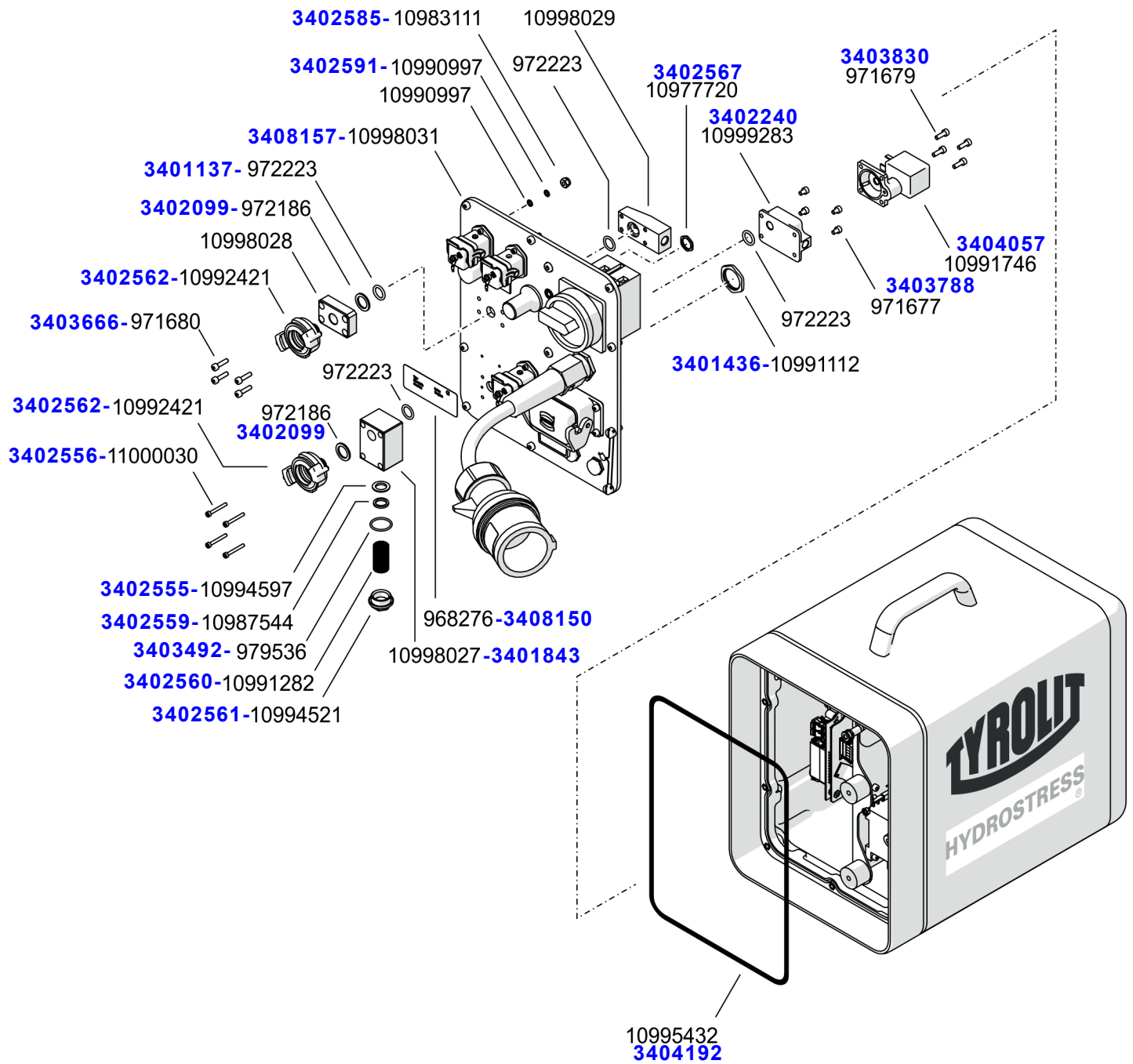

Included in #3404191 Control Unit

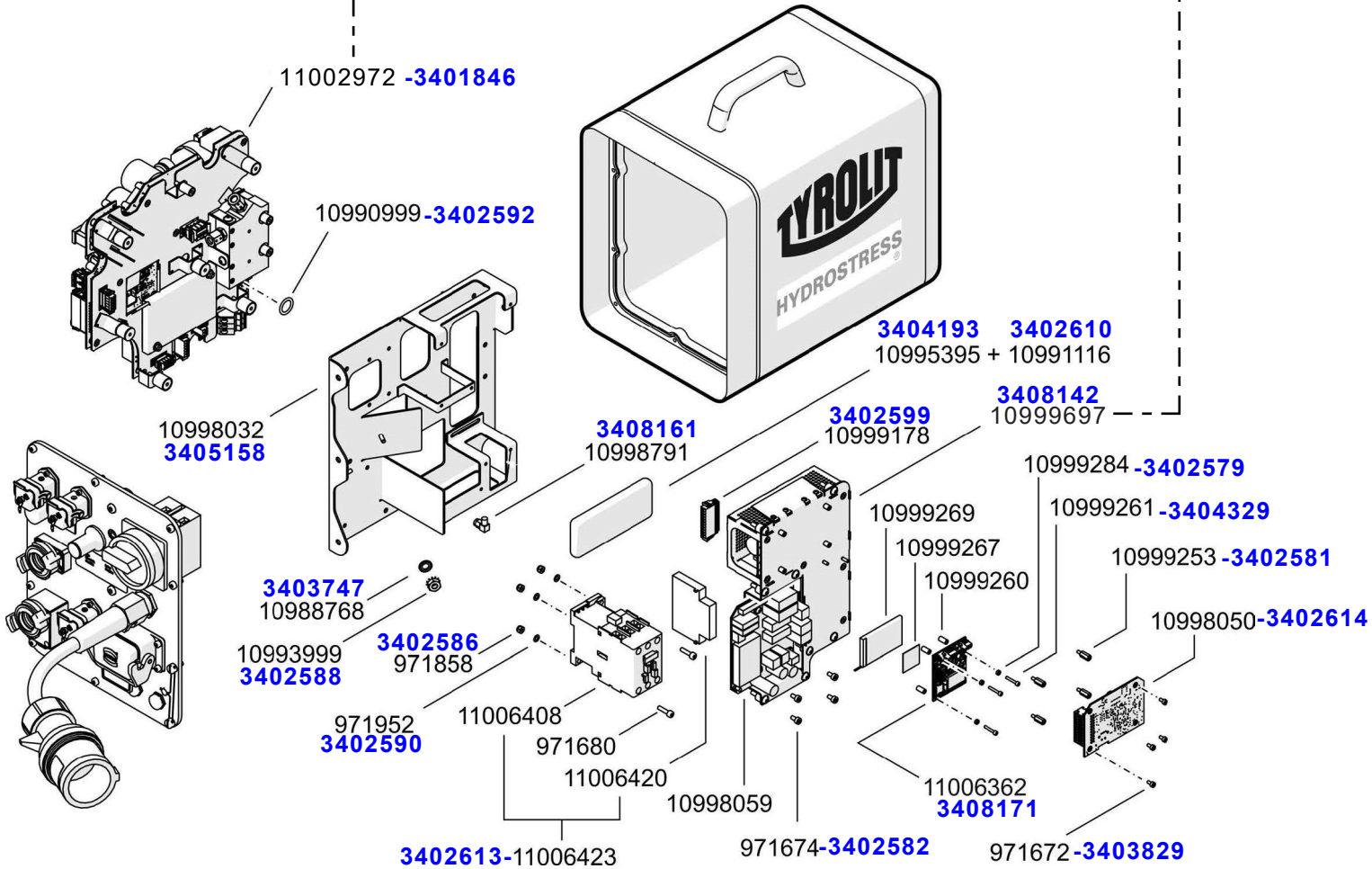

TYROLIT #	DP #	Description
962664	3401498	Type plate sticker
965167	3408149	TY-HS type plate 44x22
968276	3408150	TY-HS type plate 80x30sti
971672	3403829	Socket screw M3x6
971674	3402582	Socket screw M3x10
971677	3403788	Socket screw M4x8
971678	3401361	Socket screw M4x10
971679	3403830	Socket screw M4x12
971680	3403666	Socket screw M4x16
971703	3401046	Socket screw M6x10
971816	3403622	Countersunk screw M4x10
971858	3402586	Lock nut M4 thin head
971952	3402590	Washer M4
972186	3402099	Copper seal G1/4
972219	3400164	O-Ring 10.00x2.50 N 70
972223	3401137	O-ring 12.00x2.50 N 70
979536	3403492	O-ring 20.00x2.00 N 70
10977720	3402567	Counter nut M20 br
10978090	3402583	Socket screw M3x16
10982010	3401437	Cable fitt.w/coil M25x1.5
10982248	3408151	Lead sealing Dm 8 1kg
10982249	3400724	Lead seal wire 0.5x0.3 1kg
10983111	3402585	Lock nut M3 thin head
10987544	3402559	Flat sealing to Y-filte
10988768	3403747	Serrated washer M4
10990979	3402584	All.screwextr.flhd M6x6
10990996	3402589	Socket screw M6x8 Tx RF
10990997	3402591	Corrug. washer M3
10990999	3402592	Washer dia 4.3/12/1.0
10991082	3402595	Vibr.elem. Ø25/20 M6 i/i
10991109	3408165	Ground strap 150mm
10991112	3401436	Counter nut M25x1.25
10991116	3402610	Cable tie T18L (205x2.5)
10991282	3402560	Filter insert 250µm
10991746	3404057	Water valve elect. on/off
10992421	3402562	Hose coupling GEKA 1/4 A
10993999	3402588	Self lock nut M4
10994521	3402561	Cover to Y-filter
10994597	3402555	Centring sealing
10994697	3408152	Pressure balance elem M12
10994853	3402606	Counter nut M12x1,5 plast

TYROLIT #	DP #	Description
10995395	3404193	Dehumidification bag
10995432	3404192	O-ring 302x4 CR foam
10996348	3404168	Mini Antenna 18609.2 2dBi
10996754	3402566	Main switch 32A 3-p
10996755	3402600	Cable USB WSE1621
10997716	3408153	Sticker residual voltage
10998027	3408154	Filter block
10998028	3408155	Water connection plate A
10998029	3408156	Water connection plate I
10998031	3408157	Front plate
10998032	3405158	Base
10998050	3402614	Option Board WSE
10998059	3408159	Prep. kit RC WSE1621
10998063	3402608	Hose no. 1012
10998064	3402609	Hose no. 1013
10998074	3408166	Cable contactor WSE1621P
10998076	3408167	Cable magnet valve
10998077	3401484	Cable feed motor WSE1621
10998078	3408168	Earth. cable fil.bo/starp
10998079	3408169	Earth. cable IGBT/starp.
10998080	3401487	Motor cable WSE1621P
10998097	3401818	Cable remote control
10998104	3408160	Cable mainbo. to contact.
10998746	3400440	Cap screw M5x12
10998791	3408161	Angle cupling SMA
10999052	3408162	Op. hours count 1621 com.
10999060	3408163	Feeder 3x400V 1621
10999177	3402564	Indicator lamp LED 24VDC
10999178	3402599	PHOENIX FMC 11-polig 3,5
10999253	3402581	Distance piece I/O M3x12
10999260	3402580	Distance piece Ø2.6x10
10999261	3404329	Socket screw M2.5x16 12.9
10999267	3402596	Hook-and loop tape black
10999269	3404196	Battery TS 1.3 Wh
10999283	3402240	Water valve housing nick.
10999284	3402579	Distance piece Ø2.6x 2
10999347	3408164	Antenna casing
10999348	3402244	Setup kit assy ToolSense
10999349	3408170	Ferrite Ø10.2/18.6 28

TYROLIT #	DP #	Description
10999697	3408142	Filter Board
11000030	3402556	Socket screw M3x25
11000619	3401047	Cover box WSE1621
11001191	3400789	Lenshead screw ihex M5x12RF
11002972	3401846	Main Board V2
11006362	3408171	Tool Sense module V5.1 Phot
11006420	3408173	Aux. contact 100-ESB11
11006423	3408172	Contactore E38 w/ aux cont.
11007260	3408174	Adapt.cable TS Molex-JST

NOT SHOWN		
11002971	3404191	Control Unit WSE1621
PARTS INCLUDED		
10999462	3408175	Cable Set
10999697	3408142	Filter Board
11002972	3401846	Main Board V2

EQUIPMENT AND PARTS WARRANTY

Diamond Products warrants all equipment manufactured by it against defects in workmanship or materials for a period of 1 year from the date of shipment to Customer. The responsibility of Diamond Products under this Warranty is limited to replacement or repair of defective parts at Diamond Products' Elyria, Ohio factory, or at a point designated by it, of such parts as shall appear to us upon inspection at such parts, to have been defective in material or workmanship, with expense for transportation and labor borne by Customer. In no event shall Diamond Products be liable for consequential or incidental damages arising out of the failure of any Product to operate properly.

THIS WARRANTY IS IN LIEU OF ALL OTHER WARRANTIES, EXPRESSED OR IMPLIED, AND ALL SUCH OTHER WARRANTIES ARE HEREBY DISCLAIMED.



333 Prospect Street, Elyria, Ohio 44035
(440) 323-4616 • (800) 321-5336 • Fax (800) 634-4035
www.diamondproducts.com