

# DIAMOND PRODUCTS

## WALL SAW BLADE GUARDS PARTS LIST MANUAL

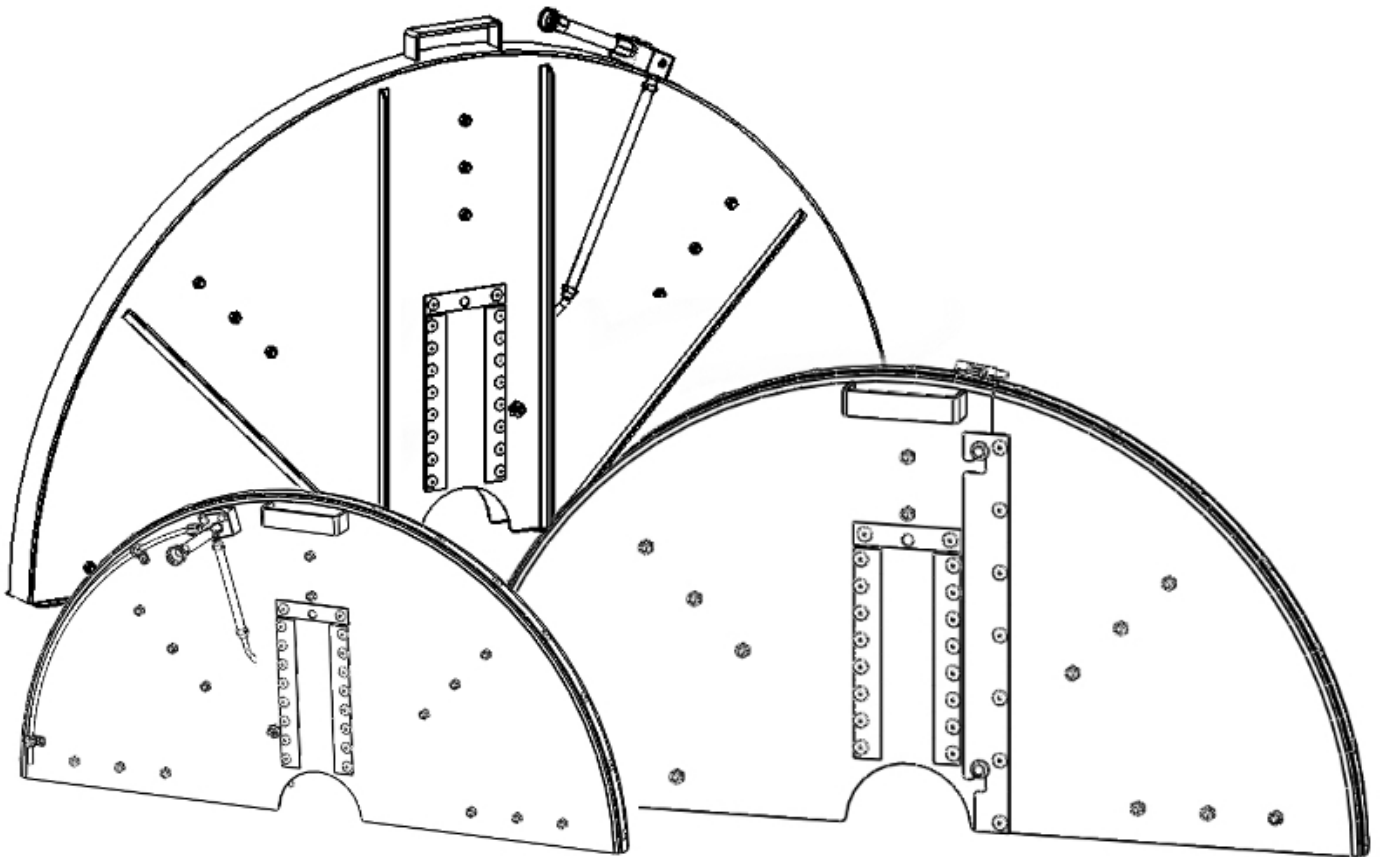

**PART #1806012**

**(SEPTEMBER 2012)**

**WWW.DIAMONDPRODUCTS.COM**

# Wall Saw Blade Guards Available

Part Number	Blade Capacity
6047038	24.00" Standard Two Piece Blade Guard
6047039	30.00" Standard Two Piece Blade Guard
6047040	36.00" Standard Two Piece Blade Guard
6047041	42.00" Standard Two Piece Blade Guard
6047042	48.00" Standard Two Piece Blade Guard
6077043	54.00" Standard Two Piece Blade Guard
6049013	60.00" Standard Two Piece Blade Guard
6049011	66.00" Standard Two Piece Blade Guard
6049009	72.00" Standard Two Piece Blade Guard
CC-24-BG-F	24.00" Standard One Piece Blade Guard
CC-30-BG-F	30.00" Standard One Piece Blade Guard
CC-36-BG-F	36.00" Standard One Piece Blade Guard
CC-42-BG-F	42.00" Standard One Piece Blade Guard
CC-48-BG-F	48.00" Standard One Piece Blade Guard
CC-54-BG-F	54.00" Standard One Piece Blade Guard
CC-60-BG-F	60.00" Standard One Piece Blade Guard
CC-66-BG-F	66.00" Standard One Piece Blade Guard
CC-70-BG-F	72.00" Standard One Piece Blade Guard
6047000	24.00" Standard Two Piece Blade Guard W/Water
6047003	30.00" Standard Two Piece Blade Guard W/Water
6047006	36.00" Standard Two Piece Blade Guard W/Water
6047009	42.00" Standard Two Piece Blade Guard W/Water
6047012	48.00" Standard Two Piece Blade Guard W/Water
6047015	54.00" Standard Two Piece Blade Guard W/Water
6049014	60.00" Standard Two Piece Blade Guard W/Water
6049012	66.00" Standard Two Piece Blade Guard W/Water
6049010	72.00" Standard Two Piece Blade Guard W/Water
6048978	24.00" Standard One Piece Blade Guard W/Water
6048979	30.00" Standard One Piece Blade Guard W/Water
6048980	36.00" Standard One Piece Blade Guard W/Water
6048981	42.00" Standard One Piece Blade Guard W/Water
6048982	48.00" Standard One Piece Blade Guard W/Water
6048983	54.00" Standard One Piece Blade Guard W/Water
6048984	60.00" Standard One Piece Blade Guard W/Water
6048985	66.00" Standard One Piece Blade Guard W/Water
6048986	72.00" Standard One Piece Blade Guard W/Water
6047050	24.00" Two Piece Flush Cut Blade Guard
6047051	30.00" Two Piece Flush Cut Blade Guard
6047052	36.00" Two Piece Flush Cut Blade Guard
6047053	42.00" Two Piece Flush Cut Blade Guard
6047054	48.00" Two Piece Flush Cut Blade Guard
6047055	54.00" Two Piece Flush Cut Blade Guard
CC-24-FL-BG	24.00" One Piece Flush Cut Blade Guard
CC-30-FL-BG	30.00" One Piece Flush Cut Blade Guard
CC-36-FL-BG	36.00" One Piece Flush Cut Blade Guard
CC-42-FL-BG	42.00" One Piece Flush Cut Blade Guard
CC-48-FL-BG	48.00" One Piece Flush Cut Blade Guard
CC-54-FL-BG	54.00" One Piece Flush Cut Blade Guard

6047020	24.00" Two Piece Flush Cut Blade Guard W/Water
6047021	30.00" Two Piece Flush Cut Blade Guard W/Water
6047022	36.00" Two Piece Flush Cut Blade Guard W/Water
6047023	42.00" Two Piece Flush Cut Blade Guard W/Water
6047024	48.00" Two Piece Flush Cut Blade Guard W/Water
6047025	54.00" Two Piece Flush Cut Blade Guard W/Water
6048987	24.00" One Piece Flush Cut Blade Guard W/Water
6048988	30.00" One Piece Flush Cut Blade Guard W/Water
6048989	36.00" One Piece Flush Cut Blade Guard W/Water
6048990	42.00" One Piece Flush Cut Blade Guard W/Water
6048991	48.00" One Piece Flush Cut Blade Guard W/Water
6048992	54.00" One Piece Flush Cut Blade Guard W/Water

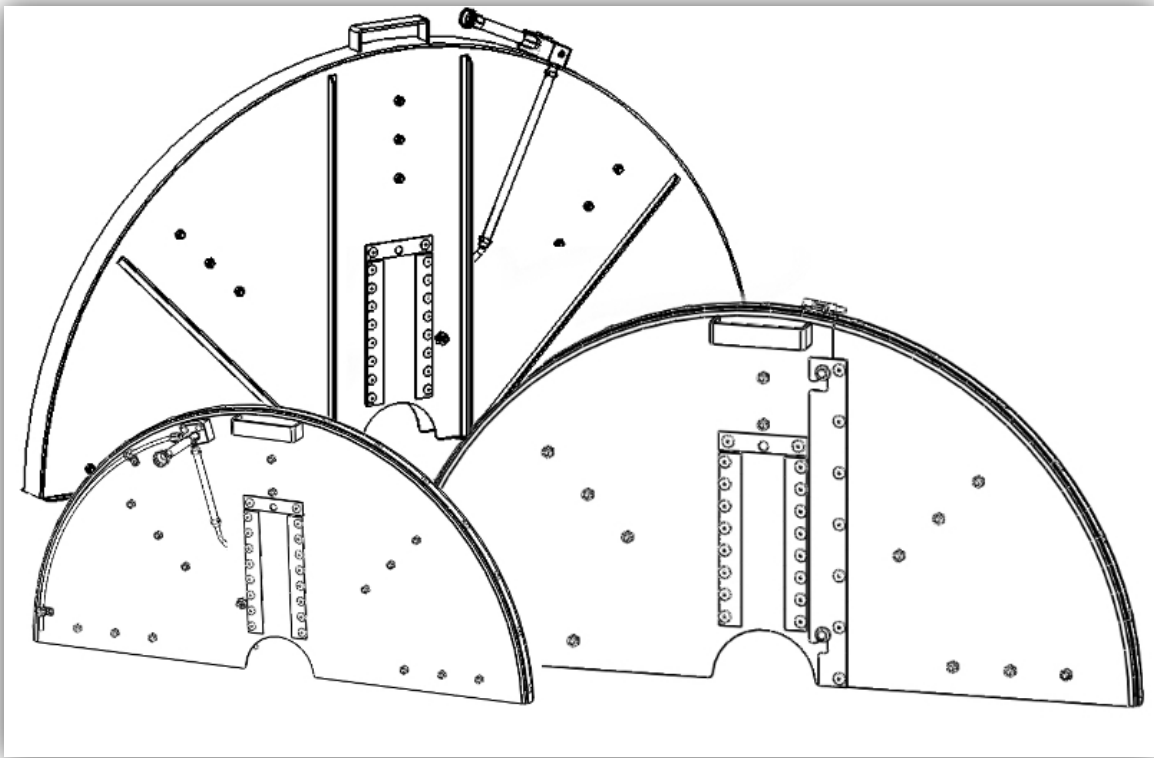

# TWO PIECE FLUSH CUT WALL SAW BLADE GUARD

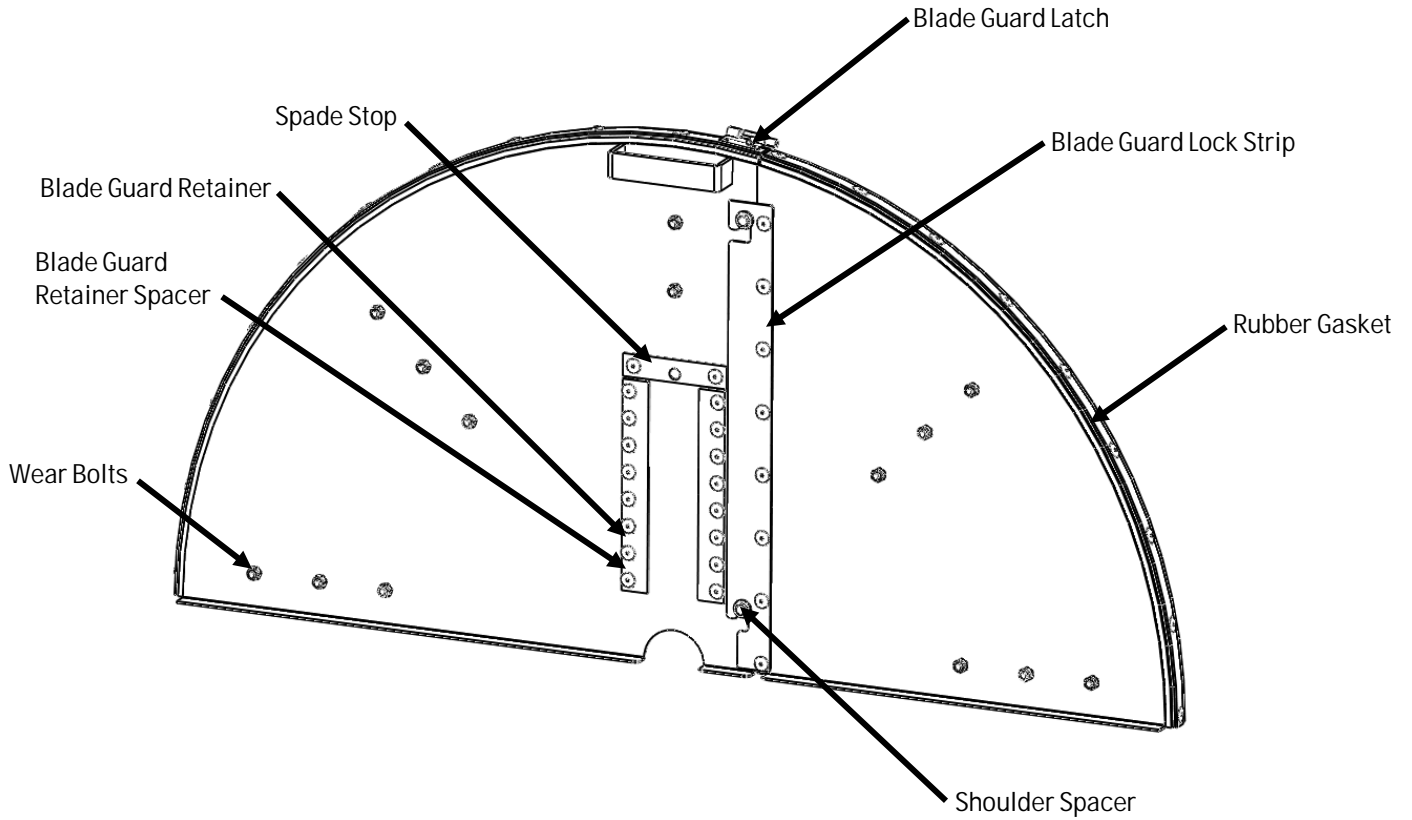

**Two Piece Flush Cut Blade Guards Size**

Blade Guard Assembly	6047050	6047051	6047052	6047053	6047054	6047055
Blade Capacity	24.00"	30.00"	36.00"	42.00"	48.00"	54.00"
<b>Part Number</b>						
Blade Guard Lock Strip	2500082	2500085	2500088	6079450	6079449	6079448
Retainer	2505049	2505049	2505049	2505049	2505049	2505049
Retainer Spacer	2505050	2505050	2505050	2505050	2505050	2505050
Blade Guard Latch	2500101	2500101	2500101	2500101	2500101	2500101
Shoulder Spacer	2500231	2500231	2500231	2500231	2500231	2500231
(1/4"-20 Nylon Locknut)	2900010	2900010	2900010	2900010	2900010	2900010
(1/4"-20x.625" Hex Cap Screw)	2900023	2900023	2900023	2900023	2900023	2900023
Wear Bolts						
(5/16"-18 Hex Nut)	2900141	2900141	2900141	2900141	2900141	2900141
(5/16"-18 x .750" Hex Cap Screw)	2900019	2900019	2900019	2900019	2900019	2900019
Spade Stop	2505048	2505048	2505048	2505048	2505048	2505048
Rubber Gasket (Measured in Inches Of Part Number (2500594))	42.00"	50.00"	60.00"	72.00"	80.00"	88.00"





# ONE PIECE WALL SAW FLUSH CUT BLADE GUARD

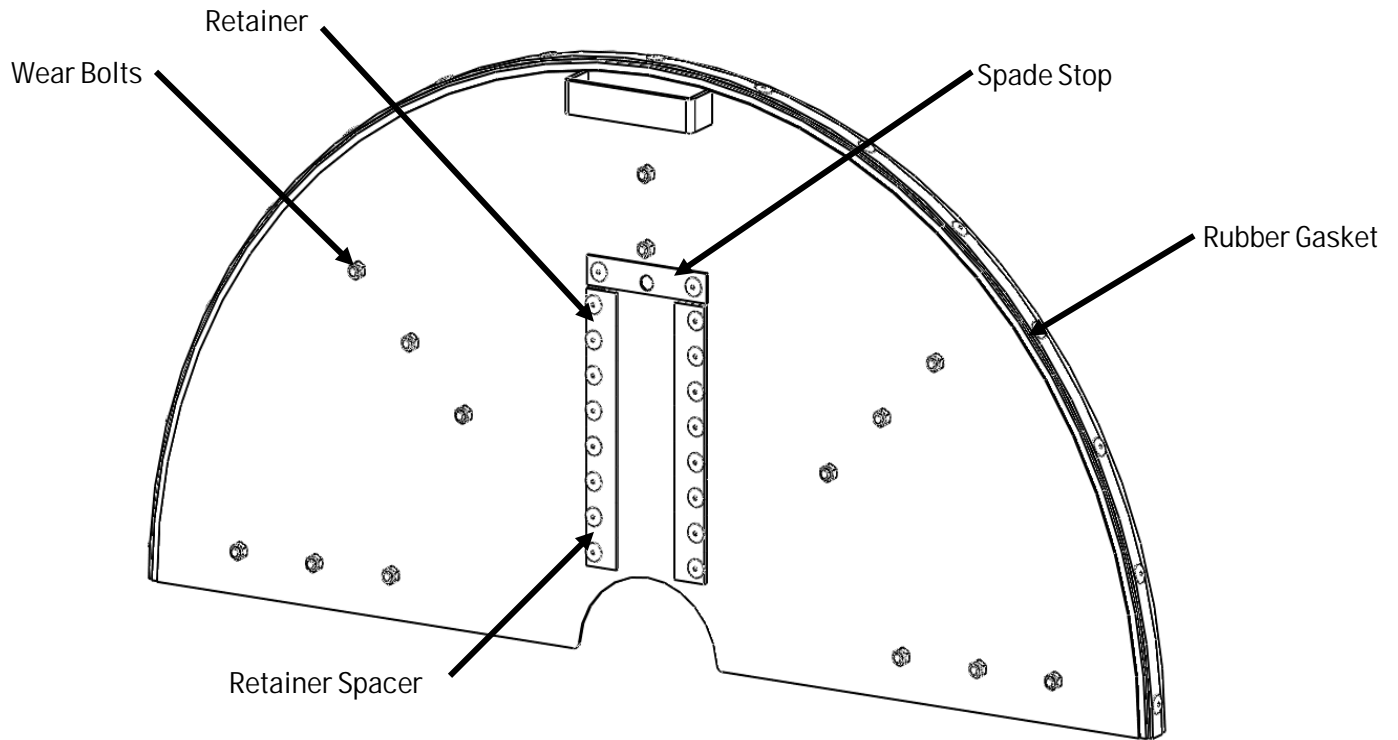

## One Piece Flush Cut Blade Guard

Blade Guard Assembly	CC-24-FL-BG	CC-30-FL-BG	CC-36-FL-BG	CC-42-FL-BG	CC-48-FL-BG	CC-54-FL-BG
Blade Capacity	24.00"	30.00"	36.00"	42.00"	48.00"	54.00"
<b>Part Number</b>						
Retainer	2505049	2505049	2505049	2505049	2505049	2505049
Retainer Spacer	2505050	2505050	2505050	2505050	2505050	2505050
Spade Stop	2505048	2505048	2505048	2505048	2505048	2505048
Wear Bolts						
(5/16-18 Hex Nut)	2900141	2900141	2900141	2900141	2900141	2900141
(5/16-18 x .750" Hex Cap Screw)	2900019	2900019	2900019	2900019	2900019	2900019
Rubber Gasket ( Measured in inches of Part #2500594 )	42.00"	50.00"	60.00"	72.00"	80.00"	88.00"

# ONE PIECE FLUSH CUT BLADE GUARD WITH WATER

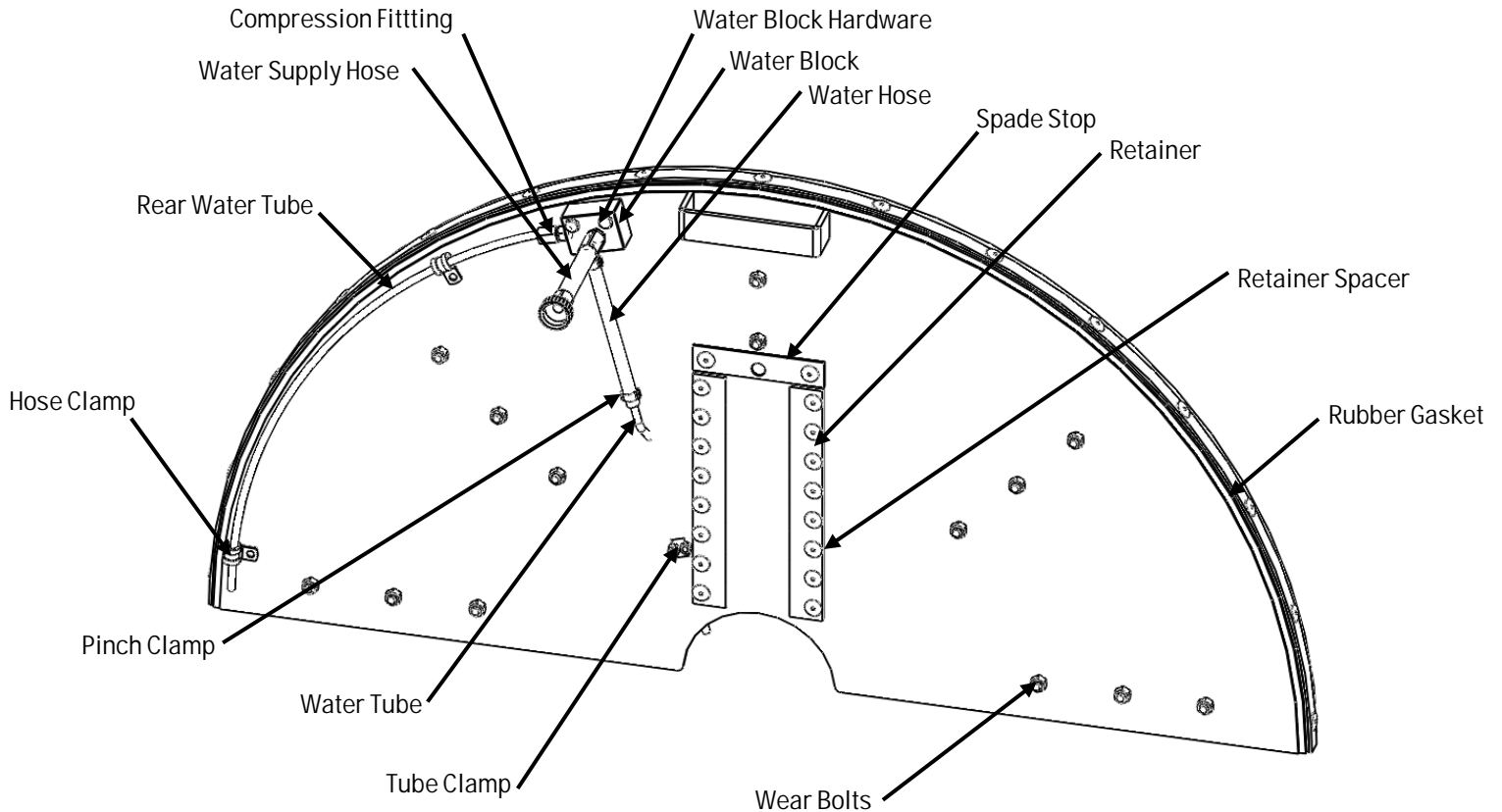

One Piece Flush Cut Blade Guard With Water						
Blade Guard Assembly	6048987	6048988	6048989	6048990	6048991	6048992
Blade Capacity	24.00"	30.00"	36.00"	42.00"	48.00"	54.00"
Part Number						
Water Supply Hose	3205544	3205544	3205544	3205544	3205544	3205544
Compression Fitting	3201276	3201276	3201276	3201276	3201276	3201276
Water Block Hardware						
(1/4"-20 x 1.50" Hex Cap Screw)	2900052	2900052	2900052	2900052	2900052	2900052
(1/4"-20 Nylock Hex Nut)	2900010	2900010	2900010	2900010	2900010	2900010
Water Block	2507136	2507136	2507136	2507136	2507136	2507136
Water Hose (Inches of Part #3200063)	4.00"	6.00"	7.00"	11.00"	14.00"	18.00"
Spade Stop	2505048	2505048	2505048	2505048	2505048	2505048
Retainer	2505049	2505049	2505049	2505049	2505049	2505049
Retainer Spacer	2505050	2505050	2505050	2505050	2505050	2505050
Rubber Gasket (Inches of Part# 2505065)	42.00"	50.00"	60.00"	72.00"	80.00"	88.00"
Wear Bolts						
(5/16-18 Hex Nut)	2900141	2900141	2900141	2900141	2900141	2900141
(5/16-18 x .750" Hex Cap Screw)	2900019	2900019	2900019	2900019	2900019	2900019
Tube Clamp	2500214	2500214	2500214	2500214	2500214	2500214
Water Tube	6040470	6040470	6040470	6040470	6040470	6040470
Pinch Clamp	3201041	3201041	3201041	3201041	3201041	3201041
Hose Clamp	2502914	2502914	2502914	2502914	2502914	2502914
Rear Water Tube (Inches Of Part Number (1101557)	10.00"	12.00"	16.00"	24.00"	28.00"	32.00"









## EQUIPMENT AND PARTS WARRANTY

Diamond Products warrants all equipment manufactured by it against defects in workmanship or materials for a period of one (1) year from the date of shipment to Customer.

The responsibility of Diamond Products under this Warranty is limited to replacement or repair of defective parts at Diamond Products' Elyria, Ohio factory, or at a point designated by it, of such parts as shall appear to us upon inspection at such parts, to have been defective in material or workmanship, with expense for transportation and labor borne by Customer.

In no event shall Diamond Products be liable for consequential or incidental damages arising out of the failure of any Product to operate properly.

Integral units such as engines, electric motors, batteries, transmissions, etc., are excluded from this Warranty and are subject to the prime manufacturer's warranty.

**THIS WARRANTY IS IN LIEU OF ALL OTHER WARRANTIES, EXPRESSED OR IMPLIED, AND ALL SUCH OTHER WARRANTIES ARE HEREBY DISCLAIMED.**

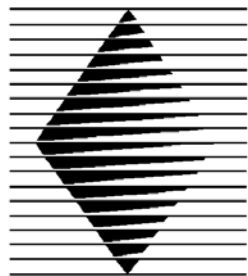

# DIAMOND PRODUCTS

333 Prospect Street, Elyria, Ohio 44035  
(440) 323-4616 • (800) 321-5336 • Fax (440) 323-8689  
[www.diamondproducts.com](http://www.diamondproducts.com)